



Raccordi in ottone giallo

yellow brass fittings

Raccorderie / Emiliane

I nostri articoli sono costruiti con materiali conformi alle normative vigenti in stabilimenti tecnologicamente all'avanguardia.

Our articles are produced according to the applicable regulations in technologically advanced establishments.

1 INTRODUZIONE

G.T.COMIS è in grado di offrire alla propria Clientela una gamma completa di raccordi filettati in ottone.

Le dimensioni disponibili coprono un intervallo molto vasto, da ¼" a 4", garantendo accoppiamenti ottimali con praticamente tutti i tipi di tubi disponibili sul mercato dell'idrotermosanitaria e quello industriale

La maggior parte dei raccordi G.T.COMIS sono disponibili anche nella versione cromata, preferita, garantendo migliore pulizia esterna, negli impieghi domestici e in quello alimentare.

2 MATERIALI

I raccordi G.T.COMIS immessi sul mercato con il loro marchio RACCORDERIE EMILIANE sono realizzati esclusivamente con materiali conformi alla normativa vigente.

Nel caso specifico dei raccordi di ottone, la lega utilizzata è la:

CW617N (UNI EN12165) per i particolari stampati la cui composizione chimica percentuale è:

	Cu	Pb	Fe	Al	Sn	Si	Ni	Zn	Peso Specifico g/cm ³
MIN	57%	1,9%	0	0	0	0	0	Resto	8,4
MAX	59%	2,5%	0.3%	0.05%	0.3%	0.20%	0.3%	Resto	

e la CW614N (Uni 12164) per i particolari ricavati da barra

	Cu	Pb	Fe	Al	Sn	Si	Ni	Zn	Peso Specifico g/cm ³
MIN	57%	2,7%	0	0	0	0	0	Resto	8,4
MAX	59%	3,0%	0.3%	0.05%	0.3%	0.20%	0.3%	Resto	

3 FILETTATURE

I raccordi G.T.COMIS immessi sul mercato con il loro marchio RACCORDERIE EMILIANE, possono essere realizzati con accoppiamento secondo UNI EN 10226-1 o secondo UNI EN ISO 228-1. Tutte le filettature sono sbovate.

• FILETTATURA UNI EN 10226-1 (ex ISO 7)

Nella filettatura conforme alla norma UNI EN 10226-1 (ex ISO 7) l'accoppiamento è a tenuta sul filetto. La filettatura è del tipo conico per l'esterno (maschio) e cilindrica per quella interna (femmina) ed è quindi perfettamente idonea alla realizzazione di impianti di distribuzione di gas combustibili secondo quanto disposto dalle norme EN 1775 ed UNI 7129.

Nel caso di accoppiamento con tubi in acciaio, non è escluso l'impiego di mezzi di tenuta come canapa con mastici adatti (tranne che per gli impianti a GPL), nastro di politetrafluoruro di etilene o altri idonei materiali. Ovviamente **l'impiego, specialmente della canapa, deve essere molto limitato evitando coppie di serraggio troppo elevate che porterebbero, avendo il raccordo un filetto conico, alla rottura dello stesso.**

Le giunzioni con tubi di rame possono essere realizzate mediante giunzione meccanica, tenendo presente che giunzioni e raccordi meccanici non devono essere impiegati nelle tubazioni sotto traccia ed in quelle interrate. I raccordi con cui si esegue l'accoppiamento possono essere di rame, di ottone o di bronzo (secondo UNI EN ISO 4063 ed UNI EN 1254-1).

• FILETTATURA UNI EN ISO 228-1

Nella filettatura conforme alla norma ISO 228-1 l'accoppiamento non è a tenuta sul filetto ed entrambe la filettature sono cilindriche. Nella figura a lato sono evidenziate le grandezze caratteristiche della filettatura conforme alla UNI EN 10226-1 ed UNI EN ISO 228-1.

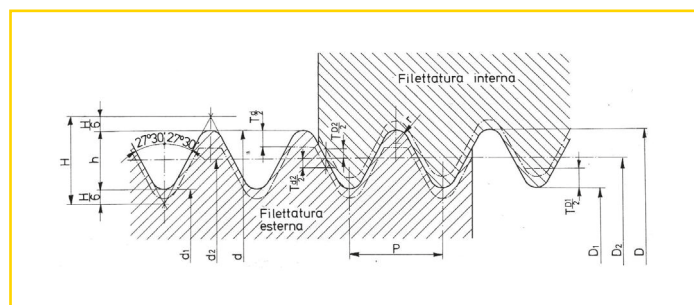
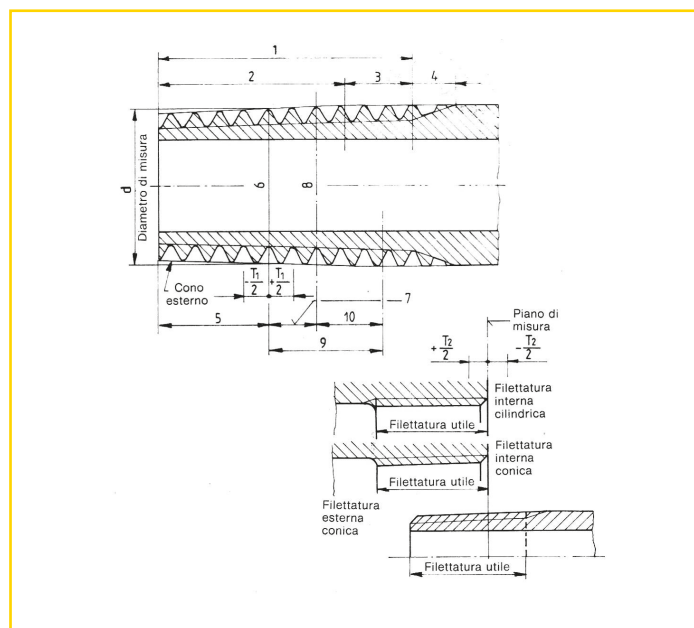

4 PRESSIONI AMMISSIBILI

Nel prospetto che segue sono riportate le pressioni ammissibili per i raccordi filettati in funzione del loro diametro e della temperatura di esercizio.

DIMENSIONI	PRESSIONE DI ESERCIZIO - BAR	
	Fino a 120° C	Fino a 225° C
da ¼" a ¾"	25	16
da 1" a 2"	16	10
da 2 ½" a 4"	10	6

1 INTRODUCTION

G.T. COMIS can offer to his customers a complete range of threaded brass fittings.

Sizes available cover a very wide range, from 1/4" to 4", ensuring optimal couplings with virtually all types of pipes available on the hydro-thermo-sanitary market, in the industrial sector. Most fittings GT Comis are also available in chrome version, and having a more simple cleaning preferred for domestic and in food industry uses

2 MATERIALS

G.T.COMIS with their brand RACCORDERIE EMILIANE produces fittings exclusively using materials that comply with the applicable regulations.

In brass fittings production, the alloy used is CW617N used forged fittings (UNI EN 12165) whose chemical composition percentage is:

	Cu	Pb	Fe	Al	Sn	Si	Ni	Zn	Density g/cm ³
MIN	57%	1,9%	0	0	0	0	0	Resto	8,4
MAX	59%	2,5%	0.3%	0.05%	0.3%	0.20%	0.3%	Resto	

and CW614N (UNI EN 12164) used for bar machined fittings.

	Cu	Pb	Fe	Al	Sn	Si	Ni	Zn	Density g/cm ³
MIN	57%	2,7%	0	0	0	0	0	Resto	8,4
MAX	59%	3,0%	0.3%	0.05%	0.3%	0.20%	0.3%	Resto	

3 THREADS

GT Comis with their brand RACCORDERIE EMILIANE, can realize fittings with coupling according to UNI EN 10226-1 or according to UNI EN ISO 228-1. All threads are blurred.

• THREAD UNI EN 10226-1 (ex ISO 7)

According to UNI EN 10226-1 pipe threads where pressure-tight joints are made on the threads. The male thread is conical, the female is cylindrical and are perfectly suitable for installations of distribution of gas in compliance with UNI EN 1775 and UNI 7129.

When coupling with steel pipes, is not excluded the use of hemp or sealing mastic (except for PG), ethylene politetrafluoruro tape or other suitable materials. **Obviously, the use (especially of hemp) should be very limited without tightening too much because having the fitting a conical thread, would, break it.**

Joints with copper pipes may be made by mechanical connections, taking into account that couplings and mechanical fittings shall not be used in the pipe chase and those laying underground. The fittings with which you joint pipes can be copper, brass or bronze (UNI EN ISO 4063 and UNI EN 1254-1).

• THREAD UNI EN ISO 228-1

In compliance with the standard the coupling is not made on the threads. In the case fittings made according to UNI EN ISO 228-1, both the threads are cylindrical

In the figure are shown the characteristic of the threads in compliance with UNI EN 10226-1 and UNI EN ISO 228-1.

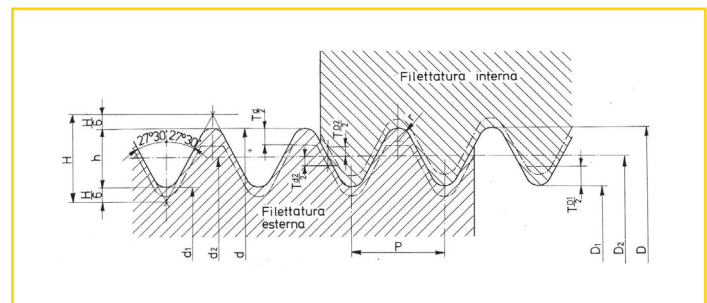
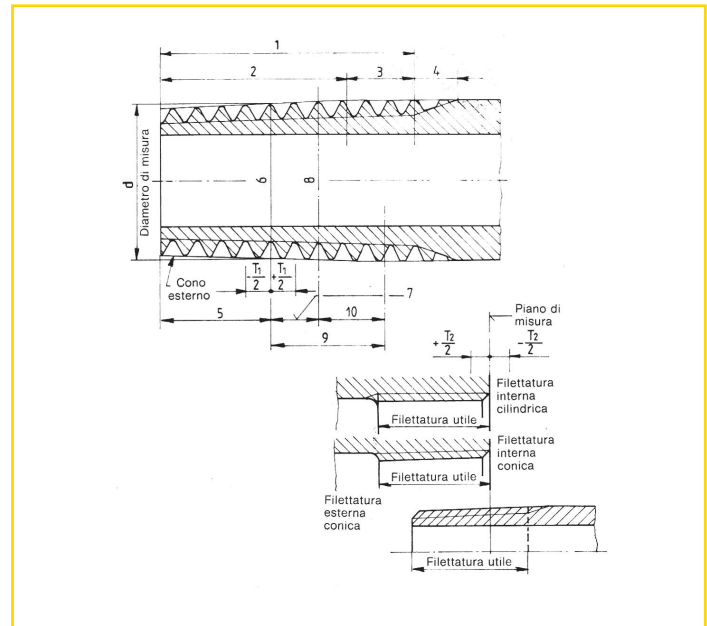

4 ALLOWABLE PRESSURE

The following table shows the allowable pressure for the fittings according to their diameter and temperature.

DIMENSIONS	MAXIMUM PRESSURE BAR	
	Up to 120° C	Up to 225° C
da 1/4" a 3/4"	25	16
da 1" a 2"	16	10
da 2 1/2" a 4"	10	6

ART. 2

Gomito a 90° F.F.
F.F. yellow brass elbow joint.

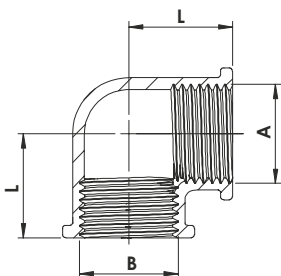
**Fig. 90**

Codice/Code	Ø AxB	L mm	Conf./Pack		cad./€ each
1185056	1/4"	17,0	10	200	1,48
1185057	3/8"	21,0	10	200	1,62
1185058	1/2"	22,0	10	140	1,77
1185059	3/4"	24,8	10	100	2,60
1185060	1"	31,8	10	50	4,16
1185061	1"1/4	42,8	1	30	7,66
1185062	1"1/2	46,4	1	26	11,48
1185063	2"	55,5	1	14	17,36
1185064	2"1/2	68,2	1	5	41,20
1185065	3"	73,0	1	2	64,72
1185067	4"	95,7	1	1	120,60

ART. 4

Gomito F.F. per impieghi speciali:
navale e gas.
F.F. yellow brass elbow joint.

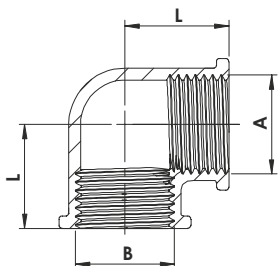
**Fig. 90
PER IMPIEGHI SPECIALI:
NAVALE E GAS**

Codice/Code	Ø AxB	L mm	Conf./Pack		cad./€ each
1185092	1/2"	26,5	10	140	2,48
1185093	3/4"	47,0	10	80	3,30
1185094	1"	42,0	10	50	7,06

ART. 6

Gomito F.F. ridotto.
F.F. yellow brass reduced elbow joint.

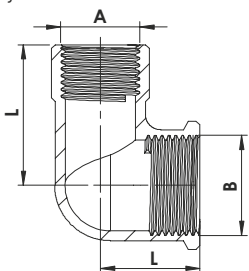
**Fig. 90 R**

Codice/Code	Ø AxB	L mm	Conf./Pack		cad./€ each
1185070	1/2"x3/4"	27,5	10	80	5,00
1185071	1/2"x1"	33,0	10	45	8,24
1185072	3/4"x1"	33,0	10	45	7,36

ART. 8

Gomito a 90° M.F.
M.F. yellow brass elbow joint.

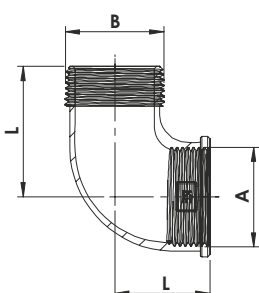
**Fig. 92**

Codice/Code	Ø AxB	L1 mm	L2 mm	Conf./Pack		cad./€ each
1185256	1/4"	20,0	25,0	10	200	1,56
1185257	3/8"	21,0	28,0	10	200	1,65
1185258	1/2"	25,0	30,1	10	170	1,86
1185259	3/4"	26,8	34,2	10	100	2,80
1185260	1"	38,6	47,0	10	50	5,00
1185261	1"1/4	40,3	55,2	10	35	7,50
1185262	1"1/2	45,3	65,4	1	26	13,25
1185263	2"	53,3	66,5	1	13	21,18
1185264	2"1/2	68,2	85,2	1	4	51,50
1185265	3"	73,0	90,5	1	4	61,78
1185267	4"	95,7	105,0	1	1	88,24

ART. 10

Gomito 90° M.F. per impieghi speciali: navale e gas.
M.F. yellow brass elbow joint.



Fig. 92
PER IMPIEGHI SPECIALI:
NAVALE E GAS

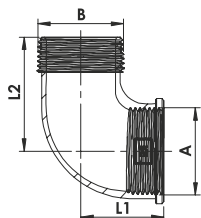

Codice/Code	Ø A	L1 mm	L2 mm	Conf./Pack		cad./€ each
1185292	1/2"	28,0	34,5	10	160	2,50
1185293	3/4"	32,3	40,2	10	80	4,56
1185294	1"	38,2	49,0	10	50	7,36

ART. 11

Gomito con flangia in ottone giallo.
MF yellow brass elbow with flange.



Codice/Code	Ø	Conf./Pack		cad./€ each
1181808	MF 1/2"	10	150	3,82
1185073	FF 1/2"	10	150	3,82

ART. 12

Bocchettone a gomito F.F. sede conica.
Yellow brass F.F. conic seat bent pipe union.



Fig. 96

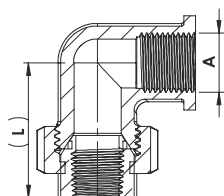

Codice/Code	Ø A	L mm	Conf./Pack		cad./€ each
1186158	1/2"	53,0	10	50	10,30
1186159	3/4"	59,2	10	40	14,12
1186160	1"	65,9	10	20	19,12
1186161	1"1/4	76,6	1	10	25,90
1186162	1"1/2	81,6	1	10	29,42
1186163	2"	90,0	1	8	43,25

ART. 14

Bocchettone a gomito M.F. sede conica.
Yellow brass M.F. conic seat bent pipe union.



Fig. 98

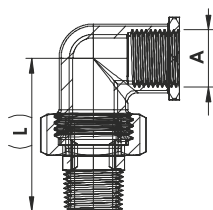

Codice/Code	Ø A	L mm	Conf./Pack		cad./€ each
1186108	1/2"	70,5	10	50	11,18
1186109	3/4"	80,0	10	30	15,30
1186110	1"	87,0	10	20	20,00
1186111	1"1/4	101,9	1	8	28,55
1186112	1"1/2	104,0	1	8	33,83
1186113	2"	117,6	1	6	47,10

ART. 16

Gomito a 45° F.F.
F.F. yellow brass elbow 45°.



Fig. 120

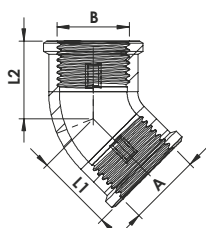

Codice/Code	Ø AxB	L1 mm	L2 mm	Conf./Pack		cad./€ each
1188008	1/2"	22,4	22,4	10	150	3,54
1188009	3/4"	24,7	24,7	10	100	4,72
1188010	1"	26,2	26,2	10	50	5,90
1188011	1"1/4	30,1	30,1	1	30	7,65
1188012	1"1/2	36,0	36,0	1	15	9,42
1188013	2"	38,2	38,2	1	6	16,00

ART. 18

Gomito a 45° M.F.
M.F. yellow brass elbow 45°.

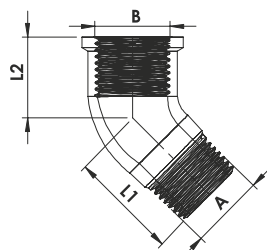
**Fig. 121**

Codice/Code	Ø AxB	L1 mm	L2 mm	Conf./Pack		cad./€ each
1188108	1/2"	30,3	22,8	10	150	3,24
1188109	3/4"	33,7	23,0	10	100	4,56
1188110	1"	38,6	26,8	10	60	6,50
1188111	1"1/4	45,8	33,0	1	36	9,42
1188112	1"1/2	45,8	38,1	1	15	12,36
1188113	2"	53,1	42,5	1	6	18,25

ART. 20

Raccordo a TEE.
TEE yellow brass joint

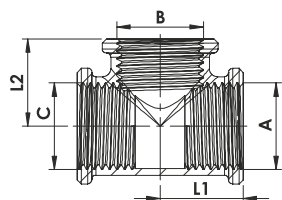
**Fig. 130**

Codice/Code	Ø AxBxC	L1 mm	L2 mm	Conf./Pack		cad./€ each
1185456	1/4"	17,7	17,5	10	120	1,83
1185457	3/8"	21,0	21,1	10	120	2,04
1185458	1/2"	20,0	21,1	10	120	1,98
1185459	3/4"	25,4	25,3	10	70	3,24
1185460	1"	30,8	32,0	10	40	5,24
1185461	1"1/4	41,9	41,0	1	26	9,42
1185462	1"1/2	46,8	47,0	1	18	12,36
1185463	2"	52,5	51,0	1	10	18,55
1185464	2"1/2	70,0	70,0	1	4	47,20
1185465	3"	75,0	75,0	1	2	68,00
1185467	4"	92,5	92,5	1	1	112,00

ART. 22

TEE per impieghi speciali: navale e gas.
Heavy TEE yellow brass joint.

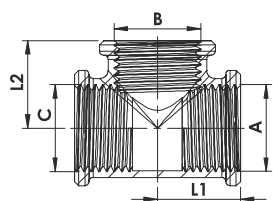
**Fig. 130**
PER IMPIEGHI SPECIALI:
NAVALE E GAS

Codice/Code	Ø AxBxC	L1 mm	L2 mm	Conf./Pack		cad./€ each
1185492	1/2"	24,8	24,9	10	100	3,40
1185493	3/4"	30,3	30,3	10	50	5,60
1185494	1"	34,9	35,5	10	35	8,30
1185496	1" 1/2	48	48	1	18	19,15

ART. 24

TEE ridotto.
Reduced TEE yellow brass.

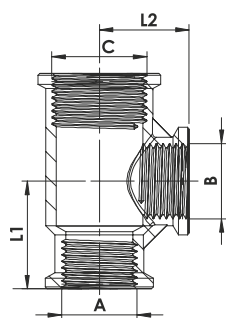
**Fig. 130 R**

Codice/Code	Ø AxBxC	L1 mm	L2 mm	Conf./Pack		cad./€ each
1185470	3/4"x1/2"x3/4"	30,0	25,0	10	80	3,84
1185469	3/4"x1/2"x1/2"	26,0	25,6	10	60	6,18
1185471	1"x1/2"x1"	27,5	29,6	10	50	5,60
1185485	1"x1"x1/2"	32,5	32,5	10	20	10,00
1185472	1"x3/4"x1"	37,0	36,9	10	40	6,78

ART. 26

Croce.
Yellow brass cross.



Fig. 180

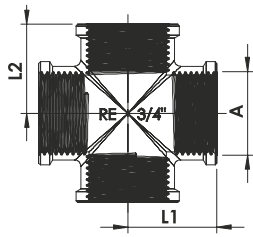

Codice/Code	Ø A	L1 mm	L2 mm	Conf./Pack		cad./€ each
1186758	1/2"	23,4	23,4	10	80	3,10
1186759	3/4"	28,3	28,3	10	40	4,12
1186760	1"	35,0	35,0	10	30	7,65
1186761	1"1/4	40,0	40,0	1	20	16,50
1186762	1"1/2	46,5	46,5	1	15	23,00
1186763	2"	56,5	56,5	1	6	29,50

ART. 28

Manicotto.
Yellow brass coupling.



Fig. 270

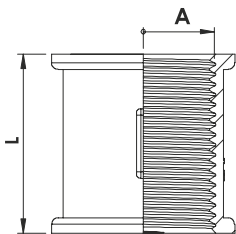

Codice/Code	Ø	L	Conf./Pack		cad./€ each
1185656	1/4"	17,5	10	500	0,77
1185657	3/8"	30,0	10	300	1,12
1185658	1/2"	30,0	10	240	1,33
1185659	3/4"	33,0	10	150	1,83
1185660	1"	30,5	10	100	2,50
1185661	1"1/4	36,2	1	60	4,42
1185662	1"1/2	40,0	1	50	5,90
1185663	2"	50,0	1	30	9,12

ART. 30

Nipples doppio.
Yellow brass nipples.



Fig. 280

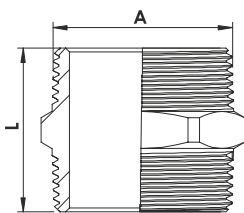

Codice/Code	Ø A	L mm	Conf./Pack		cad./€ each
1185856	1/4"	22,3	10	500	0,62
1185857	3/8"	28,0	10	400	0,77
1185858	1/2"	29,3	10	380	0,89
1185859	3/4"	30,4	10	240	1,25
1185860	1"	34,5	10	140	2,10
1185861	1"1/4	39,6	1	70	3,83
1185862	1"1/2	41,00	1	65	4,86
1185863	2"	52,2	1	36	7,50
1185884	2"1/2	61,4	1	10	21,78
1185885	3"	64,0	1	6	31,80
1185887	4"	68,3	1	2	56,00

ART. 32

Nipples conico per impieghi speciali: navale e gas.
Heavy yellow brass nipples.



Fig. 280
**PER IMPIEGHI SPECIALI:
NAVALE E GAS**

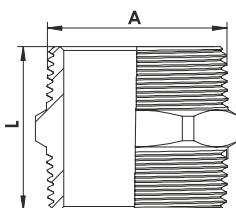

Codice/Code	Ø A	L mm	Conf./Pack		cad./€ each
1185892	1/2"	40,0	10	250	1,55
1185893	3/4"	43,9	10	150	2,54
1185894	1"	47,4	10	80	3,53
1185896	1" 1/2	57,0	1	36	8,24

ART. 34

Tappo vite maschio.
Yellow brass M cap.

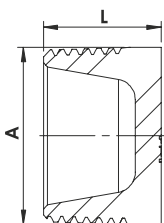
**Fig. 290**

Codice/Code	Ø A	L mm	Conf./Pack		cad./€ each
			📦	📦	
1185756	1/4"	14	10	1000	0,45
1185757	3/8"	15	10	750	0,55
1185758	1/2"	19,5	10	650	0,70
1185759	3/4"	17,3	10	400	1,10
1185760	1"	20,2	10	230	2,04
1185761	1"1/4	35,6	1	80	3,55
1185762	1"1/2	25,8	1	80	4,42
1185763	2"	33,6	1	60	7,08

ART. 36

Tappo vite femmina.
Yellow brass F cap.

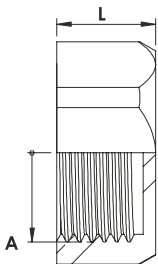
**Fig. 300**

Codice/Code	Ø A	L mm	Conf./Pack		cad./€ each
			📦	📦	
1186556	1/4"	10,8	10	1000	0,56
1186557	3/8"	9,7	10	600	0,60
1186558	1/2"	10,2	10	600	0,68
1186559	3/4"	12,5	10	350	0,95
1186560	1"	13,0	10	200	1,72
1186561	1"1/4	15,9	1	150	2,55
1186562	1"1/2	15,6	1	100	3,24
1186563	2"	20	1	60	5,90

ART. 38

Bocchettone diritto F.F. sede conica.
Yellow brass F.F. conic pipe union.

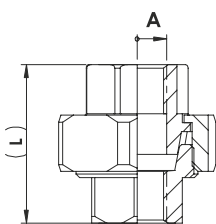
**Fig. 340**

Codice/Code	Ø	L mm	Conf./Pack		cad./€ each
			📦	📦	
1185157	3/8"	38,3	10	100	9,42
1185158	1/2"	45,2	10	70	8,55
1185159	3/4"	46,3	10	40	10,90
1185160	1"	50,4	10	40	13,85
1185161	1"1/4	58,5	1	28	18,25
1185162	1"1/2	67,5	1	15	23,60
1185163	2"	68,1	1	12	35,30

ART. 40

Bocchettone diritto M.F. sede conica.
Yellow brass M.F. conic pipe union.

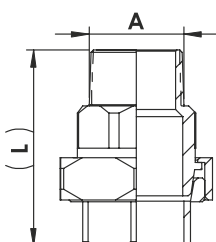
**Fig. 341**

Codice/Code	Ø A	L mm	Conf./Pack		cad./€ each
			📦	📦	
1185108	1/2"	62,7	10	80	9,42
1185109	3/4"	67,1	10	50	11,80
1185110	1"	71,5	10	30	14,15
1185111	1"1/4	83,8	1	22	20,90
1185112	1"1/2	89,9	1	16	27,10
1185113	2"	95,6	1	10	37,30

ART. 42

Tuttavite.
Yellow brass nipple.



Fig. 531

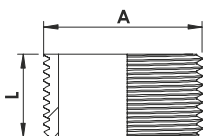

Codice/Code	Ø A	L mm	Conf./Pack		cad./€ each
1185873	1/2"	30,0	10	350	1,48
1185874	3/4"	30,0	10	250	1,78
1185875	1"	33,0	10	100	2,53
1185876	1"1/4	40,0	1	70	3,68
1185877	1"1/2	45,0	1	70	5,30
1185878	2"	50,0	1	40	8,25

ART. 44

Distribuzione a 4 vie.
Yellow brass reducing coupling.



Fig. 223

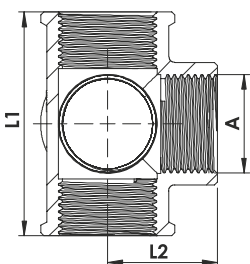

Codice/Code	Ø A	L1 mm	L2 mm	Conf./Pack		cad./€ each
1186608	1/2"	54,0	27,0	10	60	8,83
1186609	3/4"	65,0	34,1	10	40	11,78
1186610	1"	75,5	37,0	10	25	23,00
1186611	1"1/4	88,0	44,0	1	15	26,50
1186612	1"1/2	97,0	50,5	1	10	35,30

ART. 46

Manicotto ridotto F.F..
Yellow brass reducing coupling.



Fig. 240

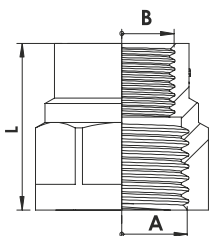

Codice/Code	Ø AxB	L mm	Conf./Pack		cad./€ each
1185558	1/2"x3/8"	27,0	10	340	1,27
1185559	3/4"x1/2"	30,2	10	160	1,83
1185560	1"x1/2"	31,2	10	120	2,68
1185561	1"x3/4"	32,0	10	90	2,50
1185562	1"1/4x1"	38,9	1	60	4,60
1185564	1"1/2x1"	37,2	1	40	8,24
1185563	1"1/2x1"1/4	39,5	1	40	7,65
1185565	2"x1"1/4	37,0	1	20	14,15
1185566	2"x1"1/2	50,0	1	40	9,72

ART. 48

Riduzione M.F..
Yellow brass reducer.



Fig. 241

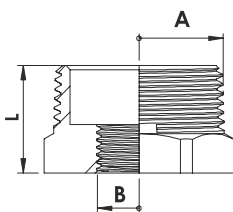

Codice/Code	Ø AxB	L mm	Conf./Pack		cad./€ each
1186453	1/4"x1/8"	12,4	10	600	0,55
1186469	3/8"x1/4"	15,1	10	600	0,65
1186455	1/2"x1/4"	17,2	10	600	0,92
1186457	1/2"x3/8"	16,6	10	600	0,62
1186454	3/4"x3/8"	17,6	10	600	1,53
1186458	3/4"x1/2"	18,7	10	350	1,05
1186463	1"x1/2"	20,5	10	180	2,10
1186459	1"x3/4"	20,5	10	180	1,77
1186471	1"1/4x1/2"	23,4	1	100	3,83
1186450	1"1/4x3/4"	24,8	1	100	3,83
1186460	1"1/4x1"	23,8	1	130	3,10
1186468	1"1/2x1/2"	23,9	1	130	6,77
1186451	1"1/2x3/4"	27,4	1	80	5,80
1186470	1"1/2x1"	24,8	1	90	4,42
1186461	1"1/2x1"1/4	26,8	1	80	3,00
1186464	2"x1"	31,1	1	50	9,42
1186465	2"x1"1/4	30,0	1	50	7,65
1186462	2"x1"1/2	30,0	1	50	6,34
1186473	2"1/2x2"	40,0	1	25	15,30
1186474	3"x2"	42,5	1	8	25,00
1186480	4"x3"	50,7	1	8	41,20

ART. 50

Nipples doppio ridotto.
Yellow brass reducing nipple.

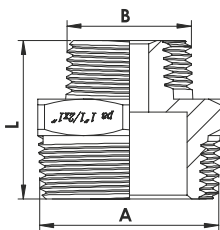
**Fig. 245**

Codice/Code	Ø AxB	L mm	Conf./Pack		cad./€ each
			🔑	📦	
1186053	1/4"x1/8"	23,0	10	400	0,62
1186057	3/8"x1/4"	25,0	10	400	0,80
1186056	1/2"x1/4"	24,5	10	400	1,06
1186058	1/2"x3/8"	27,4	10	400	0,86
1186059	3/4"x1/2"	29,6	10	280	1,30
1186061	1"x1/2"	35,2	10	130	2,18
1186060	1"x3/4"	32,9	10	130	2,22
1186068	1"1/4x1"	37,2	1	60	3,80
1186073	1"1/2x1"	44,5	1	90	5,00
1186069	1"1/2x1"1/4	44,5	1	50	5,00
1186071	2"x1"1/4	47,0	1	40	8,24
1186072	2"x1"1/2	48,8	1	40	10,60
1186075	2" 1/2x2"	62,3	1	6	22,00

ART. 52

Bocchettone diritto M.F. con OR.
O-ring seal straight yellow brass pipe union.

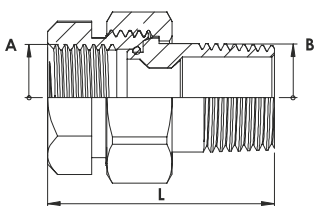
**CON O-RING**

Codice/Code	Ø AxB	L mm	Conf./Pack		cad./€ each
			🔑	📦	
1181207	3/8"	41,0	10	200	3,24
1181208	1/2"	44,5	10	150	2,86
1181209	3/4"	50,3	10	80	4,56
1181210	1"	57,6	10	50	7,36
1181211	1"1/4	66,9	1	34	12,10
1181212	1"1/2	75,0	1	20	16,18
1181213	2"	92,9	1	11	33,25

ART. 54

Bocchettone curvo M.F. con OR.
O-ring seal bent yellow brass pipe union.

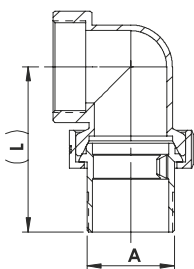
**CON O-RING**

Codice/Code	Ø A	L mm	Conf./Pack		cad./€ each
			🔑	📦	
1181407	3/8"	45,0	10	100	4,12
1181408	1/2"	48,3	10	80	3,85
1181409	3/4"	61,3	10	50	6,20
1181410	1"	71,1	10	34	9,42
1181411	1"1/4	74,6	1	20	15,30
1181412	1"1/2	91,4	1	14	23,00
1181413	2"	101,0	1	6	45,30

ART. 55

Bocchettone diritto M.F. 3 pezzi
sede piana con guarnizione.
3 pcs straight fitting M.F. with
gasket.

**NEW**

Codice/Code	Ø	L mm	Conf./Pack		cad./€ each
			🔑	📦	
1181658	1/2"		10	200	3,30
1181659	3/4"		10	120	5,25
1181660	1"		10	60	8,90
1181661	1"1/4		1	40	11,90
1181662	1"1/2		1	20	20,00
1181663	2"		1	12	34,50

ART. 56

Raccordo portagomma tipo ROMA maschio.
ROMA male hose connector.

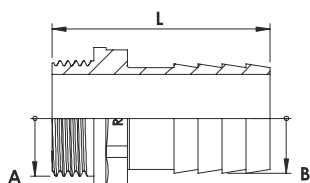

Codice/Code	Ø AxB	L mm	Conf./Pack		cad./ each
2346398	1/4"x10	33,0	10	50	1,07
2346404	3/8"x10	35,0	10	40	1,22
2346407	3/8"x15	39,0	10	400	1,30
2346411	1/2"x10	39,0	10	50	1,70
2346413	1/2"x14	39,0	10	400	0,98
2346412	1/2"x15	42,6	10	400	0,98
2346418	1/2"x20	40,0	10	280	1,24
2346409	3/4"x20	47,0	10	180	1,88
2346408	3/4"x25	50,0	10	130	2,30
2346410	1"x25	54,0	10	100	2,85
2346416	1"x30	55,0	10	90	2,80
2346422	1"1/4x30	59,0	1	80	5,30
2346423	1"1/4x35	65,5	1	40	5,90
2346424	1"1/4x40	59,0	1	80	6,50
2346420	1"1/2x40	67,0	1	48	8,55
2346421	1"1/2x45	74,0	1	10	9,30
2346444	1"1/2x50	70,0	1	10	10,40
2346460	2"x50	77,0	1	30	12,35
2346462	2"x60	95,0	1	14	16,50
2346461	2"1/2x60	95,0	1	14	21,42
2346466	3"x80	103,0	1	5	38,00
2346468	4"x100	123,0	1	2	56,00

ART. 58

Raccordo portagomma tipo Roma Femmina in ottone giallo.
Roma Female hose connector.

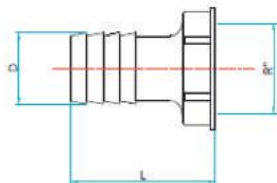

Codice/Code	ØXD	L mm	Conf./Pack		cad./ each
2346470	1/4"x13	33,0	10	50	1,12
2346472	3/8"x15	38,0	10	30	1,45
2346429	1/2"x15	39,0	10	50	1,95
2346431	1/2"x18	39,0	10	40	1,95
2346434	3/4"x20	44,0	10	25	2,10
2346435	3/4"x25	45,0	10	20	2,70
2346438	1"x25	52,0	10	30	3,30
2346439	1"x30	52,0	10	25	3,85
2346442	1"1/4x35	58,0	1	15	6,20
2346443	1"1/2x40	60,0	1	12	7,20
2346480	2"x50	77,0	1	6	15,15

ART. 59

Raccordo portagomma tipo ROMA maschio per impieghi speciali: navale e gas.
Heavy ROMA male hose connector.



**PER IMPIEGHI SPECIALI:
NAVALE E GAS**

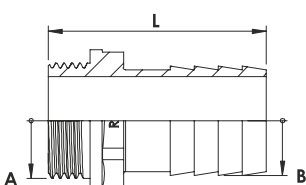

Codice/Code	Ø AxB	L mm	Conf./Pack		cad./ each
2346512	1/2"x16	48,0	10		1,70
2346518	1/2"x20	50,0	10		1,90
2346509	3/4"x20	51,0	10		2,70
2346508	3/4"x25	57,0	10		3,20
2346510	1"x25	58,5	10		4,20
2346516	1"x30	58,5	10		4,50
2346523	1"1/4x35	64,0	1		6,60
2346524	1"1/4x40	67,0	1		7,20
2346520	1"1/2x40	70,0	1		9,20
2346560	2"x50	75,0	1		13,00

ART. 70

Prolunga in ottone giallo.
Yellow brass extension.

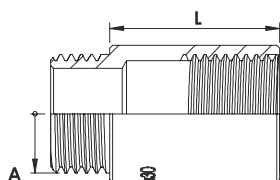

Codice/Code	cm x Ø A	L mm	Conf./Pack		cad./€ each
			🔑	📦	
1187117	1x3/8"	10,0	10	500	0,50
1187127	2x3/8"	20,0	10	300	0,80
1187137	3x3/8"	30,0	10	200	1,10
1187147	4x3/8"	40,0	10	150	1,50
1187157	5x3/8"	50,0	10	150	1,75
1187118	1x1/2"	10,0	10	450	0,68
1187121	1,5x1/2"	15,0	10	350	0,83
1187128	2x1/2"	20,0	10	280	1,06
1187132	2,5x1/2"	25,0	10	200	1,30
1187138	3x1/2"	30,0	10	200	1,54
1187148	4x1/2"	40,0	10	150	2,00
1187158	5x1/2"	50,0	10	150	2,50
1187168	6x1/2"	60,0	10	100	2,90
1187119	1x3/4"	10,0	10	350	1,05
1187122	1,5x3/4"	15,0	10	270	1,30
1187129	2x3/4"	20,0	10	200	1,65
1187139	3x3/4"	30,0	10	150	2,30
1187149	4x3/4"	40,0	10	100	2,95
1187159	5x3/4"	50,0	10	100	3,54
1187110	1x1"	10,0	10	160	1,50
1187123	1,5x1"	15,0	10	150	2,06
1187130	2x1"	20,0	10	100	2,42
1187140	3x1"	30,0	10	90	3,30

ART. 72

Prolunga in ottone giallo pesante.
Heavy yellow brass extension.

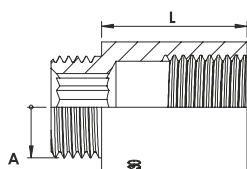

Codice/Code	cm x Ø A	L mm	Conf./Pack		cad./€ each
			🔑	📦	
1187200	1x1/2"	10,0	10	450	0,98
1187201	1,5x1/2"	15,0	10	350	1,28
1187202	2x1/2"	20,0	10	250	1,50
1187203	3x1/2"	30,0	10	200	2,30
1187204	4x1/2"	40,0	10	150	2,90
1187205	5x1/2"	50,0	10	150	3,50
1187206	6x1/2"	60,0	10	100	4,15
1187220	1x3/4"	10,0	10	350	1,30
1187221	1,5x3/4"	15,0	10	270	1,58
1187222	2x3/4"	20,0	10	200	1,95
1187223	3x3/4"	30,0	10	150	2,78
1187224	4x3/4"	40,0	10	100	3,50
1187225	5x3/4"	50,0	10	100	4,20
1187230	1x1"	10,0	10	100	1,80
1187231	1,5x1"	15,0	10	150	2,30
1187232	2x1"	20,0	10	100	2,75
1187233	3x1"	30,0	10	100	3,90

ART. 76

Prolunga ridotta M.F.
M.F. yellow brass reduced extension.



Codice/Code	Ø	Altezza mm	Conf./Pack		cad./€ each
			🔑	📦	
0168307	3/8"x1/2"	23,8	10	500	1,18
0168308	1/2"x3/4"	24,0	10	320	1,48
0168310	1/2"x1"	28,4	10	150	2,65
0168309	3/4"x1"	28,0	10	150	2,06

ART. 78

Barilotto 2 filetti.
Yellow brass two thread barrel nipple.

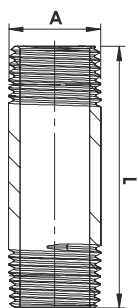

Codice/Code	Ø A	cm/L	Conf./Pack		cad./€ each
			🔑	📦	
1187308	1/2"	6	10	200	2,10
1187418	1/2"	8	10	200	2,80
1187408	1/2"	10	10	120	3,30
1187438	1/2"	12	10	150	4,40
1187458	1/2"	15	5	120	4,90
1187478	1/2"	20	5	60	6,40
1187309	3/4"	6	10	120	2,96
1187419	3/4"	8	10	100	3,90
1187409	3/4"	10	10	80	4,80
1187439	3/4"	12	10	90	6,70
1187459	3/4"	15	5	80	7,20
1187479	3/4"	20	5	40	9,60
1187310	1"	6	10	80	4,30
1187420	1"	8	10	60	6,00
1187410	1"	10	10	50	6,90
1187440	1"	12	10	60	8,70
1187460	1"	15	5	50	10,40
1187480	1"	20	5	30	13,80
1187311	1"1/4	6	10	50	6,00
1187421	1"1/4	8	10	50	8,20
1187411	1"1/4	10	10	40	10,00
1187441	1"1/4	12	10	40	11,00
1187461	1"1/4	15	5	30	13,60
1187481	1"1/4	20	5	20	16,20
1187422	1"1/2	8	10	60	11,80
1187412	1"1/2	10	10	30	13,70
1187462	1"1/2	15	10	10	20,00
1187483	1"1/2	20	5	5	26,20
1187423	2"	8	10	30	13,40
1187413	2"	10	10	20	16,70
1187463	2"	15	5	15	24,50
1187484	2"	20	1	12	33,00

ART. 79

Barilotto scorrevole M.M.
Yellow brass sliding extension.



Codice/Code	Ø	cm	Conf./Pack		cad./€ each
			🔑	📦	
1187348	1/2"	10	10	200	3,75
1187358	1/2"	15	10	160	5,20
1187371	1/2"	20	10	120	6,85
1187359	3/4"	10	10	140	5,00
1187360	3/4"	15	10	100	8,30
1187372	3/4"	20	10	80	11,25
1187369	1"	10	10	100	6,80
1187370	1"	15	10	70	11,50
1187373	1"	20	10	50	15,00

ART. 82

Raccordo per pompa excelsior curvo.
Excelsior pump bent pipe fitting.



Codice/Code	Ø	Conf./Pack		cad./€ each
		⊗	⊠	
1180209	3/4"x20	10	50	6,00
1180214	3/4"x25	10	50	7,80
1180210	1"x25	10	50	8,50
1180219	1"x30	10	30	12,80
1180211	1"1/4x30	1	10	13,00
1180212	1"1/2x40	1	10	21,30
1180213	2"x50	1	6	36,00

ART. 84

Raccordo per pompa excelsior dritto.
Excelsior pump straight pipe fitting.



Codice/Code	Ø	Conf./Pack		cad./€ each
		⊗	⊠	
1180409	3/4"x20	10	80	4,50
1180414	3/4"x25	10	80	5,90
1180415	1"x25	10	80	6,40
1180419	1"x30	10	30	9,20
1180411	1"1/4x30	1	50	9,60
1180412	1"1/2x40	1	10	14,90
1180413	2"x50	1	6	25,50

ART. 86

Raccordo porta gomma 3 pezzi sede conica.
Conic seat 3 part hose connector.



Codice/Code	Ø	Conf./Pack		cad./€ each
		⊗	⊠	
0220720	20x20	1	15	5,20
0220725	25x25	1	20	7,20
0220730	30x30	1	10	11,90

ART. 87

Raccordo ottone per vaso eternit dritto.
Eternit bowl straight brass pipe fitting.



Codice/Code	Ø	Conf./Pack		cad./€ each
		⊗	⊠	
1182408	1/2"	25	260	6,90
1182409	3/4"	15	195	9,40
1182410	1"	10	130	13,00
1182411	1"1/4	4	60	19,20
1182412	1"1/2	3	45	24,50
1182413	2"	1	30	31,00

ART. 88

Piletta per cassoni.
Tank drains.



Codice/Code	Ø	Conf./Pack		cad./€ each
		⊗	⊠	
1187708	1/2"	1	20	6,10
1187709	3/4"	1	20	8,20
1187710	1"	1	10	10,00

ART. 89

Ghiera in ottone giallo.
Yellow brass reducer.



Codice/Code	Ø	Altezza mm	Conf./Pack		cad./€ each
1187507	1/2"x3/8"	9,6	10	1000	0,50
1187508	3/4"x1/2"	11,0	10	800	0,64
1187510	1"x3/4"	11,6	10	500	1,05

ART. 90

Controdado piano.
Yellow brass lock nut.



Codice/Code	Ø	Spessore mm	Chiave mm	Conf./Pack		cad./€ each
1168008	1/2"	4,5	25,0	10	1000	0,50
1168009	3/4"	5,0	50,0	10	750	0,62
1168010	1"	6,0	37,0	10	600	0,86

ART. 92

Raccordo 2 pezzi FF per pompa in ottone giallo con guarnizione.
2 pieces straight FF pipe fitting for pumps.



Codice/Code	Ø	Conf./Pack		cad./€ each
6086010	3/4"x1"1/4	1	100	4,70
6086012	1"x1"1/2	1	100	6,30
6086015	1"1/4x2"	1	40	9,60

ART. 94

Raccordo a 5 vie 1".
5 ways pipe fitting.



Codice/Code	Ø	H mm	Conf./Pack		cad./€ each
2262010	1"	72	10	40	6,10
2262050	1"	92	10	30	7,50

ART. 96

Raccordo per contatore d'acqua.
Water meter pipe fitting.



Codice/Code	Ø	Conf./Pack		cad./€ each
0283602	3/4"x1/2"	10	150	2,70
0283604	1"x3/4"	10	160	4,00

ART. 98

Presca rapida in ottone.
Brass clamp.



Codice/Code	Ø	Conf./Pack		cad./€ each
1202008	1/2"x1/2"	10	120	6,30
1202009	3/4"x1/2"	10	90	8,80
1202010	1"x3/4"	10	80	21,00
1202011	1"1/4x3/4"	10	60	24,60
1202012	1"1/2x3/4"	10	80	29,80

ART. 140

Raccordo per tubo ferro in ottone giallo M tenuta metallica.
M brass pipe fitting.

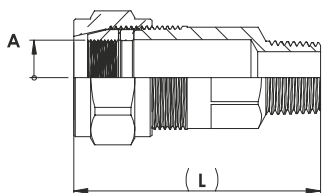

Codice/Code	Ø A	L mm	Conf./Pack		cad./€ each
1191007	3/8"	68,0	10	70	7,10
1191008	1/2"	70,0	10	70	8,00
1191009	3/4"	71,4	10	60	10,60
1191010	1"	77,3	10	35	13,50
1191011	1"1/4	83,4	1	24	22,00
1191012	1"1/2	93,5	1	20	26,50
1191013	2"	101,0	1	8	38,20

ART. 142

Raccordo per tubo ferro in ottone giallo F tenuta metallica.
F brass pipe fitting.



Codice/Code	Ø	L mm	Conf./Pack		cad./€ each
1190807	3/8"	67,0	10	70	8,20
1190808	1/2"	65,6	10	70	8,80
1190809	3/4"	68,6	10	50	10,30
1190810	1"	73,9	10	20	14,10
1190811	1"1/4	79,3	1	24	22,00
1190812	1"1/2	86,1	1	20	28,80
1190813	2"	93,5	1	12	40,00

ART. 144

Raccordo per tubo ferro in ottone giallo doppio tenuta metallica.
Double brass pipe fitting.



Codice/Code	Ø	L mm	Conf./Pack		cad./€ each
1190607	3/8"	72,0	10	60	10,60
1190608	1/2"	71,4	10	60	11,15
1190609	3/4"	76,2	10	40	14,10
1190610	1"	79,6	10	20	19,80
1190611	1"1/4	84,9	1	20	29,30
1190612	1"1/2	100,3	1	10	38,10
1190613	2"	103,3	1	10	53,00

**ART. 180**

Raccordo per tubo polietilene M in ottone giallo.
M brass polyethylene pipe fittings.

Codice Code	Ø	DN	Conf./Pack	cad. € each
1200220	1/2"	20	10 120	2,90
1200225	3/4"	25	10 70	4,85
1200232	1"	32	10 45	6,75
1200240	1"1/4	40	1 30	10,50
1200250	1"1/2	50	1 20	16,00
1200263	2"	63	1 8	23,50

**ART. 182**

Raccordo per tubo polietilene F in ottone giallo.
F brass polyethylene pipe fittings.

Codice Code	Ø	DN	Conf./Pack	cad. € each
1200420	1/2"	20	10 120	3,00
1200425	3/4"	25	10 60	5,10
1200432	1"	32	10 45	6,60
1200440	1"1/4	40	1 30	12,20
1200450	1"1/2	50	1 20	17,40
1200463	2"	63	1 10	24,30

**ART. 184**

Manicotto per tubo polietilene FF in ottone giallo.
Brass FF polyethylene coupling.

Codice Code	Ø	Conf./Pack	cad. € each
1200620	20x20	10 70	4,50
1200625	25x25	10 40	8,00
1200632	32x32	10 30	11,50
1200640	40x40	1 20	16,40
1200650	50x50	1 10	24,10
1200663	63x63	1 8	40,00

**ART. 186**

Raccordo a TEE c/derivazione F per tubo polietilene in ottone giallo.
Brass TEE polyethylene pipe fittings.

Codice Code	Ø	DN	Conf./Pack	cad. € each
1201020	1/2"	20	10 70	5,65
1201025	3/4"	25	10 30	10,30
1201032	1"	32	10 25	13,40
1201040	1"1/4	40	1 18	24,20
1201050	1"1/2	50	1 10	37,60
1201063	2"	63	1 5	54,20

**ART. 188**

TEE per tubo polietilene in ottone giallo.
Brass TEE polyethylene pipe fittings.

Codice Code	Ø	Conf./Pack	cad. € each
1201220	20x20x20	10 50	7,10
1201225	25x25x25	10 25	12,70
1201232	32x32x32	10 20	15,80
1201240	40x40x40	1 15	28,20
1201250	50x50x50	1 10	44,30
1201263	63x63x63	1 4	66,70

**ART. 190**

Gomito per tubo polietilene in ottone giallo.
Brass polyethylene elbow joint.

Codice Code	Ø	Conf./Pack	cad. € each
1201420	20x20	10 100	5,30
1201425	25x25	10 40	9,10
1201432	32x32	10 25	12,40
1201440	40x40	1 15	23,00
1201450	50x50	1 10	43,00
1201463	63x63	1 5	58,50

**ART. 192**

Gomito FF per tubo polietilene in ottone giallo.
Brass FF polyethylene elbow joint.

Codice Code	Ø	Conf./Pack	cad. € each
1201820	20x1/2"	10 130	4,05
1201825	25x3/4"	10 70	5,75
1201832	32x1"	10 40	8,50
1201840	40x1"1/4	1 15	17,10
1201850	50x1"1/2	1 10	24,00
1201863	63x2"	1 6	53,00

**ART. 194**

Gomito MF per tubo polietilene in ottone giallo.
Brass MF polyethylene elbow joint.

Codice Code	Ø	Conf./Pack	cad. € each
1201620	20x1/2"	10 130	4,05
1201625	25x3/4"	10 70	6,60
1201632	32x1"	10 40	9,50
1201640	40x1"1/4	1 15	17,15
1201650	50x1"1/2	1 10	25,60
1201663	63x2"	1 6	48,50

**ART. 196**

Boccole di rinforzo in ottone per tubo gas polietilene S 5.
S 5 gas tube brass reinforcing bushes.

Codice Code	Ø	DN	Conf. Pack	cad. € each
1202220	1/2"	20	10	1,22
1202225	3/4"	25	10	1,62
1202232	1"	32	10	2,20
1202240	1"1/4	40	10	2,80
1202250	1"1/2	50	10	5,00
1202263	2"	63	10	8,00

ISTRUZIONI DI MONTAGGIO**RACCORDI PER TUBO POLIETILENE CON ANELLO IN RESINA POLIACETALICA****ASSEMBLY INSTRUCTIONS - FITTINGS FOR PE PIPE WITH RESIN RING**

Tubo in polietilene (alta, media o bassa densità).
Polyethylene pipe (HD, BD, LD).

1. Corpo del giunto
2. Guarnizione in gomma
3. Anello di ancoraggio antisfilamento
4. Girello si serraggio

1. Joint casing
2. Rubber gasket
3. Plastic ring for mechanical fastening
4. Nut



Inserire nell'ordine sul tubo: il girello (4) l'anello (3) e la guarnizione in gomma (2).

Fit on the pipe in the following order: nut (4), ring (3) and rubber gasket.



Alloggiare il tubo all'interno del corpo del giunto e appoggiare la guarnizione (2) all'interno della svasatura tronco conica, portare l'anello (3) in contatto con la guarnizione (2).

House the pipe inside the joint casing, put the gasket (2) inside the cone-shaped flare, bring the ring (3) in touch with gasket (2).



Avvitare il girello (4) a mano, quindi fissarlo con la chiave.
Hand tight the nut (4) and then torque it with a wrench.



Fig. 90

ART. 200

Gomito a 90° F.F. in bronzo.
F.F. bronze elbow joint.

Codice Code	Ø	Conf./Pack		cad. € each
		🔗	📦	
1035758	1/2"	10	140	3,60
1035759	3/4"	10	100	5,00
1035760	1"	10	50	9,00
1035761	1"1/4	1	30	17,40
1035762	1"1/2	1	26	22,10
1035763	2"	1	14	36,90



Fig. 180

ART. 210

Croce in bronzo.
Bronze cross.

Codice Code	Ø	Conf./Pack		cad. € each
		🔗	📦	
1039058	1/2"	10	80	NON ANCORA DISPONIBILI
1039059	3/4"	10	40	
1039060	1"	10	30	
1039061	1"1/4	1	20	
1039062	1"1/2	1	15	
1039063	2"	1	6	



Fig. 92

ART. 202

Gomito a 90° M.F. in bronzo.
M.F. bronze elbow joint.

Codice Code	Ø	Conf./Pack		cad. € each
		🔗	📦	
1035958	1/2"	10	160	3,90
1035959	3/4"	10	80	5,50
1035960	1"	10	50	10,00
1035961	1"1/4	1	35	16,00
1035962	1"1/2	1	26	23,10
1035963	2"	1	13	39,70



Fig. 270

ART. 212

Manicotto in bronzo.
Bronze coupling.

Codice Code	Ø	Conf./Pack		cad. € each
		🔗	📦	
1035657	3/8"	10	200	1,62
1035658	1/2"	10	240	2,20
1035659	3/4"	10	150	3,30
1035660	1"	10	100	5,80
1035661	1"1/4	1	60	10,00
1035662	1"1/2	1	50	14,00
1035663	2"	1	27	20,00



Fig. 96

ART. 204

Bocchettone a gomito F.F. sede conica in bronzo.
Bronze F.F. conic seat bent pipe union.

Codice Code	Ø	Conf./Pack		cad. € each
		🔗	📦	
1039358	1/2"	10	50	NON ANCORA DISPONIBILI
1039359	3/4"	10	40	
1039360	1"	10	20	
1039361	1"1/4	1	10	
1039362	1"1/2	1	10	
1039363	2"	1	8	



Fig. 280

ART. 214

Nipples doppio in bronzo.
Bronze nipples.

Codice Code	Ø	Conf./Pack		cad. € each
		🔗	📦	
1038058	1/2"	10	250	1,70
1038059	3/4"	10	150	2,15
1038060	1"	10	80	3,60
1038061	1"1/4	1	36	7,70
1038062	1"1/2	1	70	9,50
1038063	2"	1	36	15,50



Fig. 98

ART. 206

Bocchettone a gomito M.F. sede conica in bronzo.
Bronze M.F. conic seat bent pipe union.

Codice Code	Ø	Conf./Pack		cad. € each
		🔗	📦	
1039458	1/2"	10	50	20,00
1039459	3/4"	10	30	20,70
1039460	1"	10	20	35,15
1039461	1"1/4	1	8	NON ANCORA DISPONIBILI
1039462	1"1/2	1	8	
1039463	2"	1	6	



Fig. 290

ART. 216

Tappo vite maschio in bronzo.
Bronze M cap.

Codice Code	Ø	Conf./Pack		cad. € each
		🔗	📦	
1038157	3/8"	10	750	2,25
1038158	1/2"	10	650	1,85
1038159	3/4"	10	400	3,20
1038160	1"	10	230	4,80
1038161	1"1/4	1	80	7,30
1038162	1"1/2	1	80	11,10
1038163	2"	1	60	18,00



Fig. 130

ART. 208

Raccordo a TEE in bronzo.
Bronze TEE.

Codice Code	Ø	Conf./Pack		cad. € each
		🔗	📦	
1036658	1/2"	10	100	4,40
1036659	3/4"	10	50	7,15
1036660	1"	10	35	12,40
1036661	1"1/4	1	26	22,20
1036662	1"1/2	1	18	29,20
1036663	2"	1	10	47,00



Fig. 300

ART. 218

Tappo vite femmina in bronzo.
Bronze F cap.

Codice Code	Ø	Conf./Pack		cad. € each
		🔗	📦	
1038258	1/2"	10	600	1,86
1038259	3/4"	10	350	2,90
1038260	1"	10	200	5,80
1038261	1"1/4	1	150	8,20
1038262	1"1/2	1	100	12,00
1038263	2"	1	60	24,00



Fig. 340

ART. 220

Bocchettone diritto F.F. sede conica in bronzo.
Bronze F.F. conic pipe union.

Codice Code	Ø	Conf./Pack		cad. € each
		⊗	⊞	
1039158	1/2"	10	70	14,80
1039159	3/4"	10	40	18,50
1039160	1"	10	40	28,10
1039161	1"1/4	1	28	46,50
1039162	1"1/2	1	15	55,00
1039163	2"	1	12	112,40



ART. 228

Raccordo portagomma tipo ROMA maschio in bronzo.
ROMA male hose connector in bronze.

Codice Code	Ø	Conf./Pack		€ cad. € each
		⊗	⊞	
1039507	3/8"x15	10	300	4,30
1039513	1/2"x14	10	400	5,45
1039514	1/2"x16	10	400	5,45
1039518	1/2"x20	10	280	5,50
1039509	3/4"x20	10	180	7,20
1039508	3/4"x25	10	130	7,55
1039510	1"x25	10	100	12,25
1039516	1"x30	10	90	12,35
1039522	1"1/4x35	1	80	16,70
1039524	1"1/4x40	1	12	19,10
1039520	1"1/2x40	1	48	21,90
1039521	1"1/2x45	1	30	22,40
1039560	2"x50	1	30	29,15
1039562	2"x60	1	5	31,60



Fig. 341

ART. 222

Bocchettone diritto M.F. sede conica in bronzo.
Bronze M.F. conic pipe union.

Codice Code	Ø	Conf./Pack		cad. € each
		⊗	⊞	
1039258	1/2"	10	80	10,00
1039259	3/4"	10	50	13,10
1039260	1"	10	30	23,80
1039261	1"1/4	1	22	46,20
1039262	1"1/2	1	16	55,50
1039263	2"	1	10	83,50



ART. 230

Giunto elastico filettato con bocchettoni in bronzo.
Bronze unions.

Codice Code	Ø	Conf./Pack		€ cad. € each
		⊗	⊞	
2324070	1"	1	10	101,30
2324071	1"1/4	1	10	136,00
2324072	1"1/2	1	10	177,00
2324073	2"	1	10	225,00



Fig. 241

ART. 224

Riduzione M.F. in bronzo.
Bronze reducer.

Codice Code	Ø	Conf./Pack		cad. € each
		⊗	⊞	
1036755	1/2"x1/4"	10	600	1,80
1036757	1/2"x3/8"	10	600	1,20
1036758	3/4"x1/2"	10	350	2,30
1036763	1"x1/2"	10	180	3,50
1036759	1"x3/4"	10	180	3,30
1036760	1"1/4x1"	1	100	5,50
1036770	1"1/2x1"	1	90	8,20
1036761	1"1/2x1"1/4	1	80	6,80
1036764	2"x1"	1	50	18,00
1036765	2"x1"1/4	1	50	16,00
1036762	2"x1"1/2	1	50	11,80



ART. 232

Saracinesca bronzo PN16.
Bronze gate valve PN16.

Codice Code	Ø	Conf./Pack		€ cad. € each
		⊗	⊞	
1039608	1/2"	20	160	11,00
1039609	3/4"	20	100	15,00
1039610	1"	10	80	18,50
1039611	1"1/4	10	50	29,00
1039612	1"1/2	5	35	37,50
1039613	2"	5	25	51,00
1039614	2"1/2	1	15	94,00
1039615	3"	1	12	117,00
1039617	4"	1	6	202,00



Fig. 245

ART. 226

Nipples doppio ridotto in bronzo.
Bronze reducing nipples.

Codice Code	Ø	Conf./Pack		cad. € each
		⊗	⊞	
1036857	1/2"x3/8"	10	400	1,95
1036858	3/4"x1/2"	10	280	2,70
1036863	1"x1/2"	10	130	NON ANCORA DISPONIBILE
1036859	1"x3/4"	10	130	4,40
1036860	1"1/4x1"	1	60	8,30
1036870	1"1/2x1"	1	90	
1036861	1"1/2x1"1/4	1	50	NON ANCORA DISPONIBILI
1036865	2"x1"1/4	1	40	
1036862	2"x1"1/2	1	40	



ART. 234

Valvola a sfera in bronzo F.F. con leva.
Bronze ball valve.

Codice Code	Ø	Conf./Pack		cad. € each
		⊗	⊞	
1039708	1/2"	20	120	17,00
1039709	3/4"	15	90	22,00
1039710	1"	8	48	33,00
1039711	1"1/4	1	30	58,00
1039712	1"1/2	1	25	68,00
1039713	2"	1	10	132,00



ART. 236

Valvola di ritegno a clapet in bronzo, sede metallo.
Bronze clapet valve

Codice Code	Ø	Conf. Pack	cad. € each
1039808	1/2"	10	17,00
1039809	3/4"	10	24,00
1039810	1"	10	34,00
1039811	1"1/4	5	47,00
1039812	1"1/2	5	54,00
1039813	2"	2	83,00



Fig. 90

ART. 240

Gomito a 90° F.F. in ottone cromato.
FF Chromium-plated brass elbow joint.

Codice Code	Ø	Conf./Pack		cad. € each
		📦	📦	
1185007	3/8"	10	200	1,90
1185008	1/2"	10	140	2,12
1185009	3/4"	10	80	3,30
1185010	1"	10	50	5,35



Fig. 92

ART. 242

Gomito a 90° M.F. in ottone cromato.
Chromium-plated brass MF elbow joint.

Codice Code	Ø	Conf./Pack		cad. € each
		📦	📦	
1185207	3/8"	10	150	2,00
1185208	1/2"	10	170	2,20
1185209	3/4"	10	100	3,40
1185210	1"	10	50	6,00



Fig. 130

ART. 244

Tee in ottone cromato.
Chromium-plated brass tee.

Codice Code	Ø	Conf./Pack		cad. € each
		📦	📦	
1185407	3/8"	10	100	2,38
1185408	1/2"	10	120	2,35
1185409	3/4"	10	70	3,65
1185410	1"	10	40	6,40



Fig. 270

ART. 246

Manicotto in ottone cromato.
Chromium-plated brass coupling.

Codice Code	Ø	Conf./Pack		cad. € each
		📦	📦	
1185607	3/8"	10	300	1,42
1185608	1/2"	10	240	1,56
1185609	3/4"	10	150	2,10
1185610	1"	10	100	3,30



Fig. 290

ART. 248

Tappo in ottone cromato M.
M chromium-plated brass cap.

Codice Code	Ø	Conf./Pack		cad. € each
		📦	📦	
1185707	3/8"	10	750	0,73
1185708	1/2"	10	650	0,82
1185709	3/4"	10	400	1,22
1185710	1"	10	230	2,50



Fig. 300

ART. 250

Tappo in ottone cromato F.
F chromium-plated brass cap.

Codice Code	Ø	Conf./Pack		cad. € each
		📦	📦	
1186507	3/8"	10	600	0,75
1186508	1/2"	10	600	0,85
1186509	3/4"	10	350	1,20
1186510	1"	10	200	1,82



Fig. 280

ART. 252

Nipples in ottone cromato.
Chromium-plated brass nipples.

Codice Code	Ø	Conf./Pack		cad. € each
		📦	📦	
1185806	1/4"	10	500	0,95
1185807	3/8"	10	400	1,00
1185808	1/2"	10	380	1,05
1185809	3/4"	10	240	1,50
1185810	1"	10	140	2,50



Fig. 245

ART. 254

Nipples di riduzione in ottone cromato.
Reduced chromium-plated brass nipples.

Codice Code	Ø	Conf./Pack		cad. € each
		📦	📦	
1186007	3/8"x1/4"	10	400	1,15
1186008	1/2"x3/8"	10	400	1,18
1186009	3/4"x1/2"	10	280	1,70
1186010	1"x3/4"	10	130	2,55



Fig. 241

ART. 256

Riduzione in ottone cromato.
MF chromium-plated brass reducer.

Codice Code	Ø	Conf./Pack		cad. € each
		📦	📦	
1186407	3/8"x1/4"	10	600	0,91
1186408	1/2"x3/8"	10	600	0,91
1186409	3/4"x1/2"	10	350	1,15
1186406	1"x1/2"	10	180	2,53
1186410	1"x3/4"	10	180	1,82



Fig. 246

ART. 258

Prolunga ridotta MF in ottone cromato.
MF chromium-plated brass extension.

Codice Code	Ø	Conf./Pack		cad. € each
		📦	📦	
0168207	3/8"x1/2"	10	500	1,42
0168208	1/2"x3/4"	10	320	2,10
0168209	3/4"x1"	10	150	2,95

**ART. 260**

Prolunga in ottone cromato.
Chromium-plated brass extension.

Codice Code	Ø	Conf./Pack		cad. € each
		📦	📦	
1187018	cm.1x1/2"	10	450	1,18
1187020	cm.1.5x1/2"	10	350	1,55
1187028	cm.2x1/2"	10	280	1,68
1187038	cm.3x1/2"	10	200	2,20
1187048	cm.4x1/2"	10	150	2,90
1187058	cm.5x1/2"	10	150	3,25
1187068	cm.6x1/2"	10	100	4,00
1187088	cm.8x1/2"	10	100	4,50
1187098	cm.10x1/2"	10	100	5,20
1187039	cm.3x3/4"	10	150	3,25
1187049	cm.4x3/4"	10	120	4,10



PESANTE

ART. 262

Prolunga in ottone cromato pesante.
Heavy chromium-plated brass extensions.

Codice Code	Ø	Conf./Pack		cad. € each
		📦	📦	
1187060	cm.1x1/2"	10	450	1,25
1187062	cm.2x1/2"	10	250	1,80
1187063	cm.3x1/2"	10	200	2,34
1187064	cm.4x1/2"	10	200	3,46
1187065	cm.5x1/2"	10	150	3,78

**ART. 264**

Riduzione ottone cromato.
MF chromium-plated brass reducer.

Codice Code	Ø	Conf./Pack		cad. € each
		📦	📦	
0168111	M1"XF1"1/4"	10	100	3,00
0168112	M1"1/4XF1"1/2"	10	80	4,40